

Aqua-Vu[®]

AV822 User Manual



Dear Valued Customer,

Thank you for choosing our product and entrusting us with your underwater viewing needs. We understand that purchasing electronics is a significant investment. At Aqua-Vu, we are committed to providing you with high-quality products along with exceptional customer service.

If you have any questions, concerns, or feedback about our product, please do not hesitate to contact us. We're always here to help and welcome any opportunity to improve our products and services.

Once again, thank you for choosing Aqua-Vu. We truly appreciate your business and look forward to serving you in the future.

Best regards,



The Aqua-Vu Team

Service and Contact Information

To obtain service you may go to www.aquavu.com/contact-us to start a case. Our customer service team will help you troubleshoot your issue and if necessary issue a Return Authorization (RA).

Contact information:

Call: 1-866-755-6303

Email: service@aquavu.com

For more information:

 www.aquavu.com

 www.facebook.com/underwaterviewing

 www.instagram.com/aquavu



Product Safety	3
Key Product Features	4
Powering Your System	5
Included With Your System	5
Charging Your system	6
Setting up your System	6
Battery Care	6
Replacing the Battery	6
Using the Camera Positioning Fin	7
Using the Controls	7
Using the Menu Options	8
Camera Deployment	8
Recording Video and Capturing Photos	9
Photo and Video Playback	9
Factory Reset	10
Playing AV822 Files on Apple Systems	10
AV822 Update For Use With Apple Products	11
Underwater Viewing Tips	12
• Boat, Bridge, Pier	
• On the Ice	13-14
Frequently Asked Questions	15
Troubleshooting	16
Warranty Information	17
Service and Contact Information	18

Safety

Aqua-Vu systems can be hazardous if not used properly. Please read the following disclaimer carefully before using the product:



Water Safety: Aqua-Vu systems are designed to be used underwater. However, please exercise caution when using the product, and make sure that you are familiar with the water conditions in which you will be using the camera. Always wear a personal flotation device and follow water safety guidelines in your area.



Ice Safety: Please exercise caution when using the product on ice, and make sure that you are familiar with the ice conditions in which you will be using the system. Always wear appropriate safety gear and follow the safety guidelines for ice fishing in your area.



Battery Safety: Most Aqua-Vu systems are equipped with a rechargeable battery. When charging your device, make sure to use the charger that is provided with the product. Do not use any other chargers, as this can cause damage to the battery and pose a fire hazard. If you plan to store the product for an extended period of time, make sure to charge the battery fully before storing it. Store the product in a cool, dry place, away from direct sunlight, heat, and moisture.



California Prop 65: This product contains chemicals known to the State of California to cause cancer, birth defects, or other reproductive harm. Please be aware that the chemicals may be present in the packaging, cords, and other components of the product. It is important to handle the product with care and to follow the instructions provided.

Additional Product Safety Reminders:

- YOUR SAFETY IS YOUR RESPONSIBILITY
- ALWAYS BE AWARE OF YOUR SURROUNDINGS, ESPECIALLY WHILE USING IN A MOVING VESSEL.
- Always keep camera cable away from ice augers, propellers, etc.
- Keep the monitor and camera away from portable heaters, radiators or other heat sources.
- Avoid wedging the camera in rocks, roots, submerged trees, or underwater debris.
- Do not store unit in damp places.
- Do not attempt to disassemble the waterproof casing of the camera or monitor. Doing so will void your warranty.
- Charge batteries only with included chargers.
- DO NOT attempt to disassemble batteries.

Key Product Features

- New super-sized 8" high resolution LCD
- Ultra Clear HD1080p Camera with 60' durable cable and depth indication (on cable)
- HDMI Out
- Industry exclusive, Revolution™ Integrated Camera Reel System (Patent #D832084)
- 9 Hours of Runtime with rechargeable Internal Lithium-Ion battery, with battery status, & USB/Wall Charger
- Removable fin & camera position clips for ice & open water use
- Built-In DVR for Recording



Powering your Aqua-Vu System

Your Aqua-Vu AV822 comes with a rechargeable lithium ion battery. Lithium ion batteries are a proven reliable and safe power source when properly maintained. Aside from charging, these batteries require no maintenance. Please see section on Battery Care.

The battery is located inside the camera screen.

Your Aqua-Vu can also be powered from an external usb power source using the supplied power adapters. Either from a usb supply such as a car or boat battery, or from 110V using the battery charger and power supply.



Charging your system with built-in charger

- Plug the power supply into the side of the monitor. When the light turns green the battery is fully charged. Replace cover when finished charging.

Included with your Aqua-Vu Camera

Your Aqua-Vu camera (with the exception of the Muti-Vu Pro) comes with the monitor, battery and camera assembled together.

Included with your system:

- Battery charger
- Camera
- Battery
- Monitor
- Storage case
- Camera positioning fin
- Mini HDMI adaptor (Standard HDMI cord not included)
- Weight
- Lanyard, 1/4 20 threaded adaptor, factory reset pin

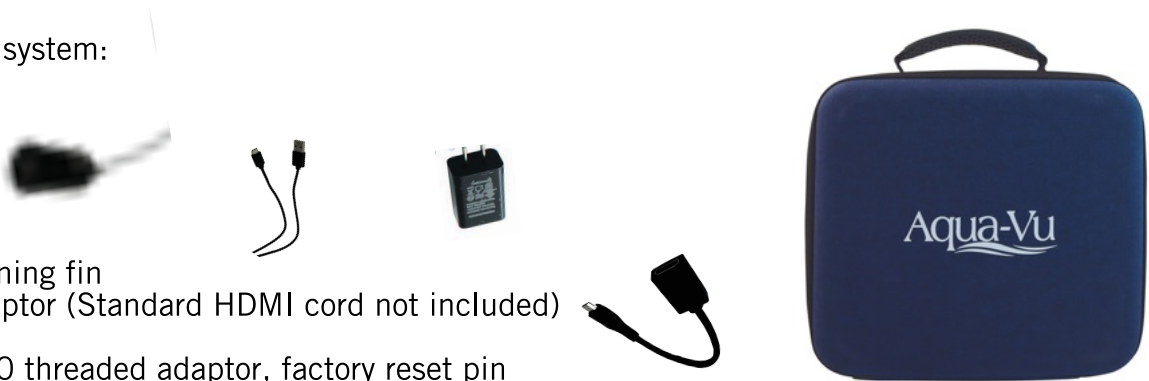

This list a guide. Please refer to the packaging and quick start guide included with your system.



Setting Up Your System

Use the included charger or power supply to charge the battery. The light on the charger or side of the monitor will turn green when the battery is fully charged. See section on "Charging the Battery" for more information. You can also power the system on, and then lightly press the power button again. A battery display with bars will display in the upper right hand corner of the screen. Four full bars indicate the system is fully charged.

Battery Care

Follow these simple guidelines for prolonged battery life and maximum runtime of your Aqua-Vu underwater viewing system.

- Fully charge the battery before first use.
- Recharge battery after each use.
- When not in use for long periods charge the battery quarterly. Alternatively you could leave the charger on. Our charges act as float chargers and will not over charge a battery.
- Only use the supplied charger or power supply.
- Store battery (system) between 30°F and 70°F. Temperatures above and below this range shorten the service life of a battery.

Replacing the battery

Your AV822 uses a Lithium Ion custom made battery. The battery is a custom size and will need to be replaced by an authorized Aqua-Vu Service Dealer. For assistance, please contact the Aqua-Vu Care Team at 866-755-6303.

Using the Camera Positioning Fin

Use the camera positioning fin to control the angle of the camera and orient the camera picture for the screen. With one hand, apply pressure to the top and bottom of the fin to create a small gap in the fin. Slide the camera cord into the gap, then insert the camera into the fin. Then power on the camera, and rotate the camera until the picture on the screen is oriented correctly. There is a notch on the camera that should be aligned with the top of the camera positioning fin. Then position the cable in the desired channel for your angle of view.

Scan to see a video

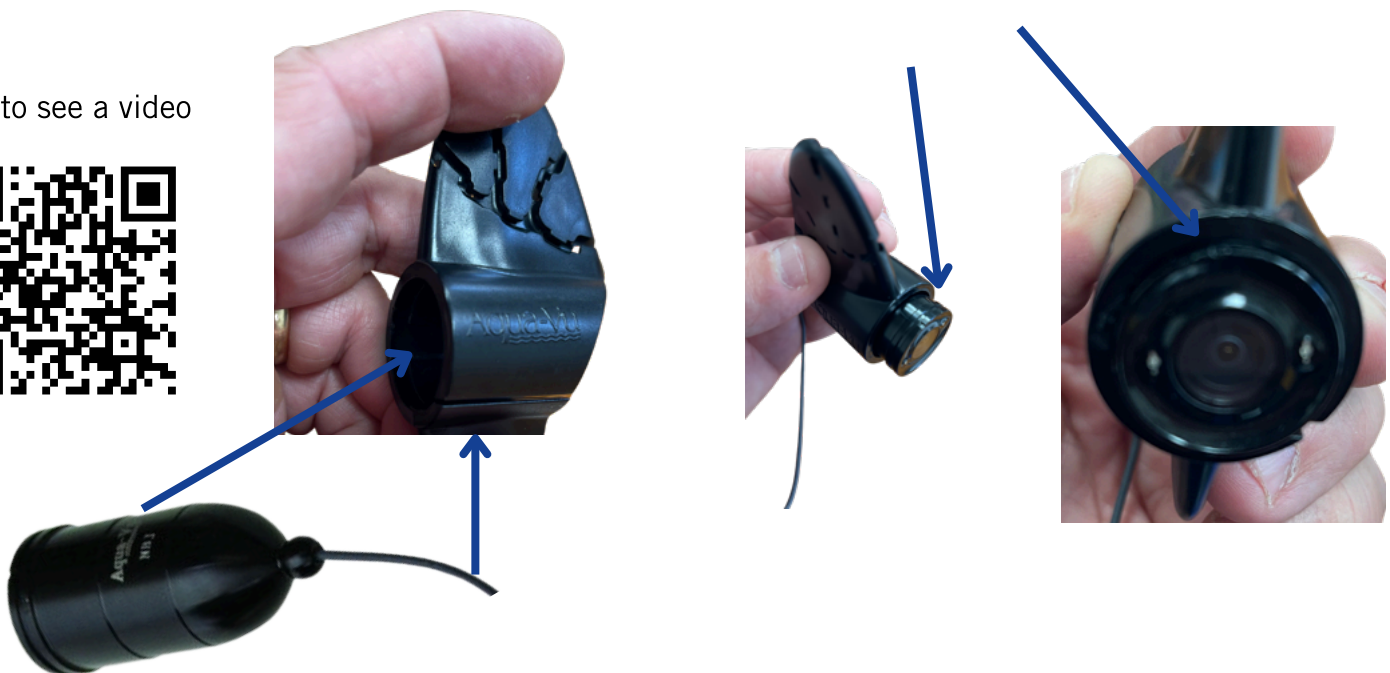

Using the controls - AV822

When using the controls on your Aqua-Vu system, avoid using sharp objects to manipulate the switches. Doing so can damage the switch cover and allow water to enter the system. Use only enough force to activate the switch.



On/Off

- The power button on the shuttle base turns the system on or off.
- To turn the system on, press and hold the power button for approximately one second until the power indicator light on the monitor turns green.



Battery Status Indicator

- The battery status indicator is located in the upper right hand corner of the screen. It is a green icon shaped like a AA battery. The number of bars will decrease as the battery is depleted.



Menu

- Pressing the Menu button will show the main menu.
- Use the Menu button to navigate down the Menu.
- Use the \wedge/\vee buttons to change values.
- Using the small pin to push into the small opening below the Mini HDMI Port RESET will return settings to their default values.

Menu Options

IR Lights: Toggle On/Off Infrared Lights.

Aspect Ratio: Toggle between 16:9, 4:3 or Off.

Screen Brightness: Adjust the screen brightness setting.

Picture: Enter Picture menu to adjust Brightness, Color and Contrast or reset to factory settings.

Rotate: Allows screen orientation to be rotated.

Language: Change unit language setting.

Rec/Photo: Toggle between recording video clips or taking still images when Record button is activated.

Video Playback: Select to view or delete recorded videos.

Photo Playback: Select to view or delete captured photos.

Rec Timer: Adjust time of recorded videos between 3, 5 or 10 minute lengths.

Picture Quality: Toggle between Normal, High or Ultra High Definition.

Time Setting: Set the time and date on the system.

Time Stamp: Toggle On/Off if the timestamp is displayed.

Stored Info: Displays system information on used drive space, remaining drive space and total available drive space.

Format: Allows users to format internal drive.

Default Setting: Allows users to reset the system to factory settings.

Software Version: Displays systems current software version.

Camera Deployment

Remove camera head from camera head storage slip on side of spool. Open spool lock tap. Spool wind handle should be opened to the wind position. Using the handle, slowly unwind camera cable spool to let out desired depth of camera cable. Camera can also be deployed by slowly pulling by hand camera cable from the spool. Users should refrain from unwinding or pull too fast as this may result in the cable tangling around the spool.

For camera retrieval, use the wind handle to retrieve the camera cable onto the spool. Slow steady winding will produce the best result. Once cable is retrieved, lock the spool lock tab in place and place the camera head in a storage slip for safe transport. Fold in the wind handle.



Recording Video and Capturing Photos

Select Rec for video capture or Photo for still photos in menu options.

Press Record button to begin recording video or to take a still frame photo.

Note: Video recordings will record in previously selected lengths or 3, 5 or 10-minute clips and will continually record until the user stops recording or the internal drive becomes full.



Video and Photo Playback

Playback and Deletion for Video or Image Files

Playback

1. Select the Menu button.
2. Use Arrow buttons to highlight Video or Photo Playback.
3. Select Enter button.
5. Use Arrow buttons to highlight desired video or photo.
6. Select Enter button to begin playback



Deletion

1. Select the Menu button.
2. Use Arrow buttons to highlight Video or Photo Playback.
3. Select Enter button.
5. Use Arrow buttons to highlight desired video or photo.
6. Hold down the Menu button until a dialog box pops up asking if you are sure you want to delete the file.
7. Select and hold down the Enter button to delete the file.

Note: To delete all videos or photos use the format option.

Zoom Feature

While viewing, use Arrow buttons to toggle between 0, 1.0x, 1.5x, 2.0x, 2.5x and 3.0x zoom settings.

Maintenance

1. Keep the camera head and cable clean and free of debris.
2. Store the AV822 unit and cable in a cool, dry place when not in use.
3. Avoid exposing the AV822 unit and cable to extreme temperatures.



Factory Reset

The AV822 HD system can be reset in the event the system is locked-up. Included in the accessories pack is a small pin that is used for the reset.

With the system powered on, insert the pin into the reset port pressing the reset button until the system resets.

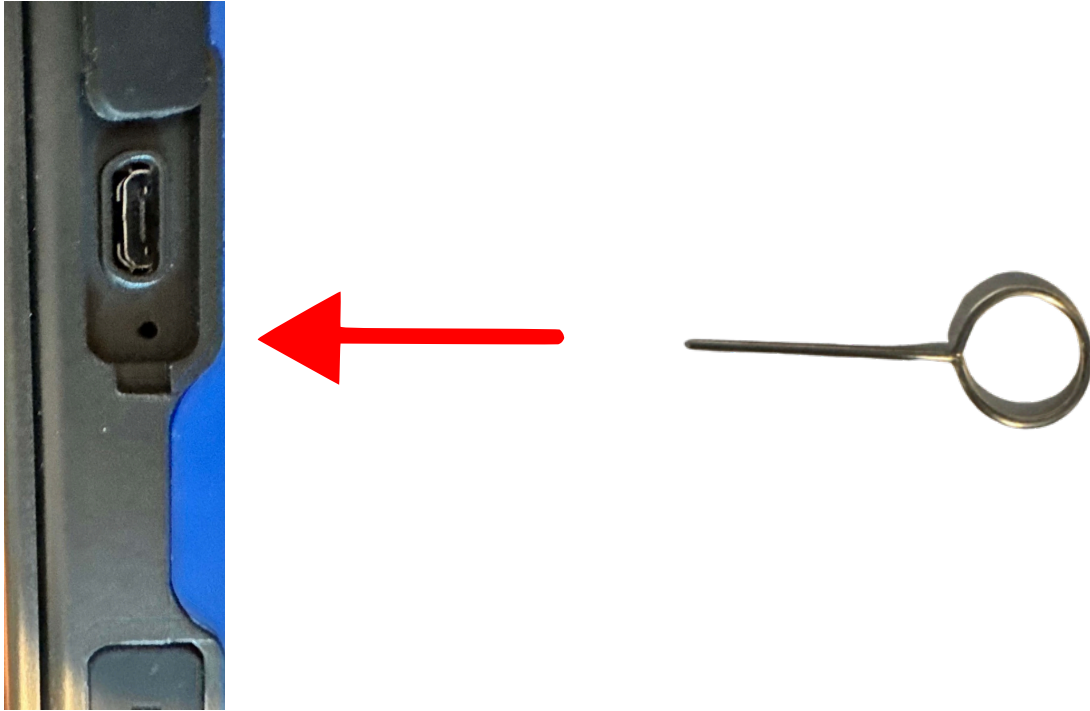

Playing AV822 Files on Apple Systems

The AV822 HD records in .avi format and Apple systems may not playback the video files in that format depending on what video players you have installed. We recommend .VLC Media Player to playback these files on Apple systems. VLC Media Player is a free program that can be easily downloaded online.

Scan the code or visit: <https://www.videolan.org/>



AV822 Update For Use With Apple Products

Please follow the below procedure to update your AV822 HD to connect and view files on Apple Systems.

Step 1. Download “Update.bin” from the link below on a PC. The file must be on a PC and not an Apple product so the AV822 can connect to the system for file transfer.

https://www.dropbox.com/s/8ayeoh36feva7b2/AV822_Update_2023-03.bin?dl=0

Step 2. With the 822 powered off, plug the charging cable into the 822’s side port. This will be the middle port on the right side of the 822. The plug has a shape that will only allow it to fit one way. Next connect the USB end of the charging cable to one of your PC computer’s USB ports.

Step 3. Power on the 822. On your computer a dialog box should pop up. If you do not see the dialog box check for it in your file explorer. The box will be titled “USB Drive D:” (Your computer may assign the drive a different letter) Inside this box should be two folders titled “Photo” and “Video”. This is the “Root” directory of your AV822.

Step 4. Locate the downloaded “Update.bin” file on your PC and Cut or Copy/Paste the file into the “Root” directory of the AV822.

Step 5. Eject the AV822 from your PC and power it down. Then power it back up. When you power it back up you should see a message about the software being updated. Follow the directions of the update message by not powering off the AV822. The update may take a few minutes.

Step 6. Once the update is complete, power down your AV822. You can now connect the AV822 to your Apple product and the computer should see the AV822 as it does on PC.

Note The AV822 records in .avi format and Apple systems may not playback the video files in that format depending on what video players you have installed. We recommend .VLC player to playback these files on Apple systems. .VLC player is a free program that can be easily downloaded online. Simply search for .VLC player and select the correct version for the system you are using.

If this does not work, please contact Customer Service at 866-755-6303 for a solution for getting your .avi files to a computer that will require using an AV Connect HD or other external media capture device.

Underwater Viewing Tips - Boat, Bridge, Pier

Aqua-Vu systems have become a popular tool for anglers, recreational boaters, scuba divers, and marine biologists. One of the key benefits of an Aqua-Vu system is the ability to get a clear view of what's happening beneath the surface of the water. However, to get the best view of the images, there are a few tips to keep in mind.

First, it's important to note that using an Aqua-Vu system while the boat is stopped or moving slowly is ideal. This will allow the camera to capture clear, stable images without the movement of the boat interfering with the view. When slowly drifting or moving, weights and trolling fins can be used to stabilize the camera, making it easier to see underwater.

To get the best view of the underwater structure or when close to the bottom, it's important to adjust the depth of the camera. This can be done manually by adjusting the camera's cable, which will change its depth in the water. It's recommended to start with the camera close to the bottom and slowly move it up to capture a wider view of the water column.

Anchoring the boat is the best way to use an Aqua-Vu system. Anchoring technology on a trolling motor or an anchor will stop the boat's movement, providing a stable platform to view the underwater images. This will also allow the user to take their time and carefully analyze the images on the system's screen.

Lastly, it's important to note that the clarity of the images will depend on the water's clarity and lighting conditions. If the water is murky, the images may be harder to see, and it's recommended to use the system in clearer water. In addition, using the system during low light conditions will provide the best underwater viewing experiences.

Underwater Viewing Tips - On the Ice

As ice fishing becomes increasingly popular, more anglers are looking for ways to improve their success rates. One tool that has become essential is the Aqua-Vu underwater system. Not only does it offer a new level of excitement and entertainment, but it also provides several advantages that can make all the difference when it comes to catching fish. Here are some benefits of using an Aqua-Vu on the ice and some tips for getting the most out of your new Aqua-Vu system.

Identifying Fish Species:

One of the most significant advantages of using an Aqua-Vu system on the ice is the ability to identify fish species. By observing the species and movement of the fish on the screen, anglers can determine what kind of fish they are targeting. This information is crucial in selecting the right bait and presentation to entice the fish to bite.

Seeing the Bottom Content:

Another advantage of using an Aqua-Vu system on the ice is the ability to see the bottom content. Understanding the type of substrate, rocks, or debris at the bottom of the lake can help anglers locate fish habitats and feeding areas. Additionally, seeing the bottom structure can help anglers determine if their lure is in the right location.

Seeing Vegetation and Fish Hiding in the Vegetation:

Aqua-Vu systems also offer a unique perspective on vegetation and fish hiding in the weeds. By observing the movement of fish around the weeds that normally are hard to see with other sonar units.

Observe and Adjust Your Presentation:

Using an Aqua-Vu system allows you to watch your bait presentation, so you know when to change your jigging sequence, color, or add fresh live bait.

Know When to Set the Hook:

One of the key benefits of using an Aqua-Vu system when ice fishing is that it allows you to see when a fish takes the bait, so you can set the hook at the perfect moment. This can significantly increase your chances of catching more fish and having a successful day on the ice.

Underwater Viewing Tips - On the Ice Continued

To use an Aqua-Vu for ice fishing, you first need to drill two holes in the ice, one for the camera and one for your fishing line. Position the camera at a 45-degree angle, either up or down, or at a 90-degree angle using the camera cable accessory. Once the camera is in place, use an ice pod or mo pod accessory to set the depth of your camera so that you can see your bait presentation.

The best viewing conditions for the Aqua-Vu are in clear water. To get more light to the camera, you can remove any snow cover and drill additional holes near your line to get more light to the camera. The depth of the water will also be a factor in how clear your image is. The deeper the camera, the darker the image will typically be.

The Aqua-Vu camera has built-in technology that is not adjustable to detect whether or not to display the image in full color or black and white. If you see your camera changing from color to black and white, it means the camera is not detecting enough light to give a full-color image.

Aqua-Vu systems are specifically designed to withstand the harsh conditions of ice fishing. These systems are built with durable materials and rugged construction to ensure they can handle the cold temperatures and challenging environments that come with ice fishing. The camera housing is typically made of high-strength materials such as polycarbonate or ABS plastic, which are both lightweight and durable.

Aqua-Vu systems also come with reinforced cable connections and waterproof seals to prevent water from entering the camera housing. This is important when ice fishing, as the camera may be exposed to snow, ice, and water on the surface of the ice. Additionally, the camera cables are often coated with a protective sheath to prevent damage from sharp ice edges. Aqua-Vu systems are built to last and can withstand the demands of ice fishing, making them a reliable and durable tool for ice anglers to use on the ice.

Frequently Asked Questions

Question	Answer
How far can I see?	Naturally, the clearer the water, the farther you can see. As a general rule, in water the camera can see twice as far as the human eye — meaning that if you can see 3 feet down you will be able to see approximately 6 feet in front of the camera. But this is just a rule of thumb. Water bodies vary in water clarity and other characteristics. For anglers studying bottom structure, 2 feet of visibility is sufficient for underwater viewing, though in very clear water, it is possible to see up to 30 feet or more.
When do I use the lights?	The Aqua-Vu lights in your Aqua-Vu camera are designed for use in low-light conditions. Turn the lights on for enhanced visibility in low light conditions.
How do I steer the camera?	For viewing in the direction of travel, attach the stabilizer fin (sold separately) to the camera housing. Slowly troll (less than 2 mph) or drift along the structure you intend to view. With fin attached, the camera will move parallel to the boat's direction of travel. Change the direction of the trolling fin to view forward or backward.
Can I splice the camera cable to obtain more length?	No. Attempting to splice in additional cable violates the waterproof integrity of the camera and cable. This will void your warranty.
How fast can I troll with my camera?	It depends on depth, and also on the length of cable you have out, which determines water resistance or “drag.” The deeper you go, with more cable out, the more drag there will be. That requires slower travel for good viewing. Generally, for optimal viewing, we recommend going less than 2 miles per hour. Remember, the slower you go, the more detail you will see. Also, the faster the bottom depth changes, the more rapidly you will need to manipulate the camera cable. You can add additional weight by hanging a downrigger ball under the trolling fin.
Can I use my Aqua-Vu in saltwater?	Yes. The Aqua-Vu 715 Saltwater system is saltwater-rated, constructed with stainless steel hardware and corrosion resistant materials. All other systems can also be used in saltwater conditions but need extra care after use. When using any system in saltwater, rinse with fresh water and wipe down with a cloth after each use.
Will my unit work in subfreezing conditions?	Aqua-Vu systems are designed to operate at temperatures ranging from -10 to 110 degrees F. Expect your battery life to decrease in cold conditions.
How wide is the camera's angle of view?	This varies by system. See specs.
Can I connect my Aqua-Vu to a TV or recording device?	Yes. You can use the video out port on the system to transmit to another monitor or recording device. The HDMI signal does not have HDCP protection and can easily be recorded.

Troubleshooting

Problem	Cause	Solution
Nothing happens, screen fails to light up when unit is turned on.	Battery not connected.	Properly connect the battery. Red to red, black to black.
	Battery not charged.	Attach battery charger and charge battery for 12-24 hours.
The screen lights up but I don't see a picture.	Camera cable is not connected.	Ensure camera is securely attached to shuttle.
	Camera cable or connectors might be damaged.	Check cable and connectors for damage. Consult the "How to Obtain Service" section of the manual.
I lowered the camera to the bottom but I can't see anything	The camera may be buried in muck.	Raise the camera off the bottom.
	The water might be very murky.	Turn the camera lights on for enhanced viewing in low light conditions.
The camera seems to work above the water but not below	The camera is not oriented correctly.	Try lowering the camera until it hovers just above bottom. You should now be able to make out the outline of the lake bottom. Without the solid reference point of the bottom, the monitor may look blank.
	The water clarity is poor.	What you see on the screen is directly related to water clarity. If the water is dirty, visibility will be limited. Again, try to keep the camera running a foot or less above the bottom.
There is a nick in the camera cable	The camera may have gotten snagged on a sharp surface.	See the "How to Obtain Service" section of this manual for instructions on replacing the camera.

Warranty Information

One Year Limited Warranty

Aqua-Vu warrants its products to be free from defects in materials and workmanship for a period of one-year from the original date of purchase. Aqua-Vu will, at its sole discretion, repair or replace any components that fail in normal use. Failures caused by abuse, misuse, alteration, or self-repair are not covered under warranty. The warranty is valid for the original owner and is non-transferable.

Register your product by returning the warranty registration card or by registering online at <https://www.aquavu.com/product-registration>

Aqua-Vu retains the exclusive right to repair or replace the unit at its discretion. The customer is responsible for shipping costs associated with returning the unit to Aqua-Vu. All of our warranty services will be charged a fee for service and shipping which must be paid in advance. It is the consumer's full responsibility to track their products sent out in the mail or other forms of delivery service. Aqua-Vu will not be liable for lost packages.

30 Day Satisfaction Guarantee

All products purchased directly from aquavu.com may be returned within 30 days of the original purchase for a full refund of the original purchase price (less any applicable shipping).

To be eligible for a refund, please confirm the following:

- The product was purchased in the last 30 days directly from Aqua-Vu.
- The product is in its original packaging.
- The product is in like new condition, as damaged returns will not be accepted. Products that do not meet these criteria will not be considered for return.

IMPORTANT. You must obtain authorization prior to sending a return or exchange. Also, please ensure the product is carefully packaged in its original packing along with the RA number received. To obtain a Return Authorization Number (RA) go to www.aquavu.com/contact-us to start a case.

Service and Contact Information

To obtain service you may go to www.aquavu.com/contact-us to start a case. Our customer service team will help you troubleshoot your issue and if necessary issue a Return Authorization (RA).

Contact information:

Call: 1-866-755-6303

Email: service@aquavu.com

For more information:



www.aquavu.com



www.facebook.com/underwaterviewing



www.instagram.com/aquavu